



## Key Features

- Four channels allowing four independent cues to run simultaneously
- Flexible channel options to customize inputs
- Modular series design
- Integrated device with onboard server (NAV:Node) and user interface (NAV:GUI)
- NAV:NET connection removes need for dedicated Estop cable
- Ability to pre-program shows
- Protective glass cover

## Description

TAIT's NAV: Antares is a modular, networked console that can operate with multiple Navigator consoles or as a standalone console. It features dual touchscreen interfaces and a multitude of channel options. The flexible channel

options allow users to customize inputs, creating the ideal programming and show interface for each specific show. Users have the ability to pre-program shows with integrated 3D previsualization to allow for offline previewing, editing and exporting of movies.

## Dimensions

Front View

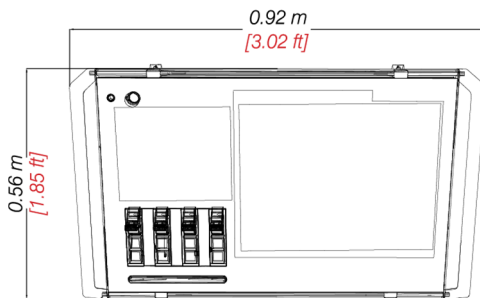

Side View

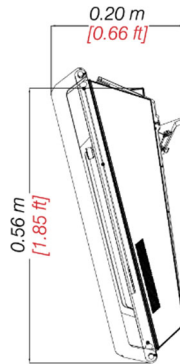

## Specifications

Display	21.3" multi-touchscreen 12.1" touchscreen
Channels	4
Estop buttons	1
Input Power	110-240 VAC 50/60 Hz
Enable Inputs	1
Front/Rear USB	1/2
NAV:NET Ports	2
Lamp Outputs	2
Monitor Outputs	2 HDMI
Dimensions	0.92 m (3'-3") x 0.57 m (1'-10") x 0.20 m (7.9")

Built-In Hold-to-Run  
Operator Switch

## Channel Options

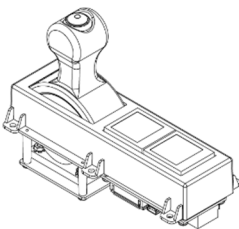

Single Axis Jog Wheel Dual  
Display Buttons

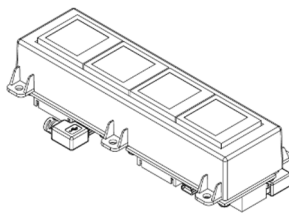

Quad Display Buttons

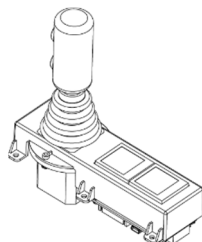

2-Axis Joystick Dual  
Display Buttons

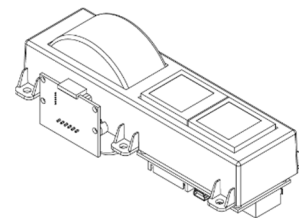

Encoder Wheel Dual  
Display Buttons